

# US SERRATED FLANGE NUT SIZE CHART

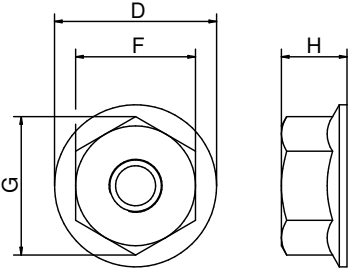

F - Width Across the Flats  
 G - Width Across Corners  
 D - Flange Diameter  
 H - Thickness

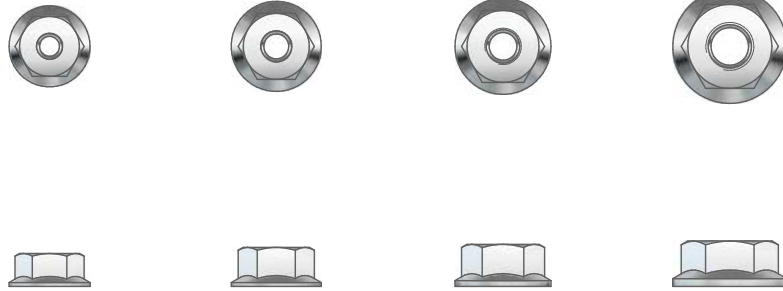

Nut Sizes	#6	#8	#10	1/4"
Thread Per Inch (TPI) - Course	32	32	24	20
Thread Per Inch (TPI) - Fine	40	36	32	28
Width Across the Flats	0.312"	0.344"	0.375"	0.438"
Width Across Corners	0.361"	0.397"	0.433"	0.505"
Flange Diameter	0.422"	0.469"	0.500"	0.594"
Thickness	0.171"	0.203"	0.219"	0.236"

"Width Across the Flats" is the same as "Wrench Size"

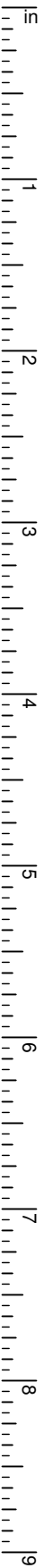

# US SERRATED FLANGE NUT SIZE CHART

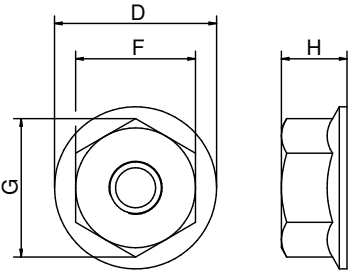

F - Width Across the Flats  
 G - Width Across Corners  
 D - Flange Diameter  
 H - Thickness

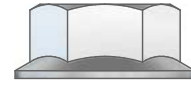
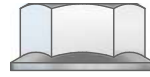
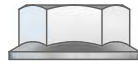

Nut Sizes	5/16"	3/8"	7/16"
Thread Per Inch (TPI) - Course	18	16	14
Thread Per Inch (TPI) - Fine	24	24	20
Width Across the Flats	0.500"	0.562"	0.678"
Width Across Corners	0.577"	0.660"	0.794"
Flange Diameter	0.680"	0.750"	0.937"
Thickness	0.283"	0.347"	0.386"

"Width Across the Flats" is the same as "Wrench Size"

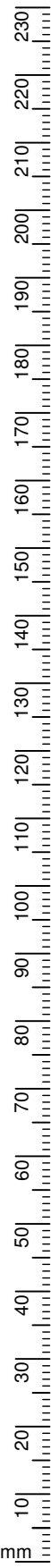
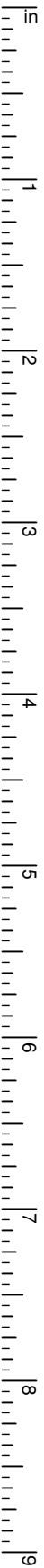

# US SERRATED FLANGE NUT SIZE CHART

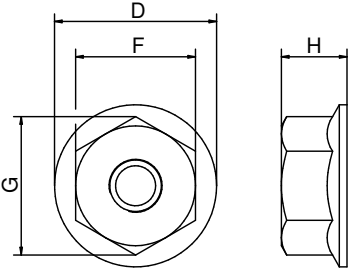

F - Width Across the Flats  
 G - Width Across Corners  
 D - Flange Diameter  
 H - Thickness

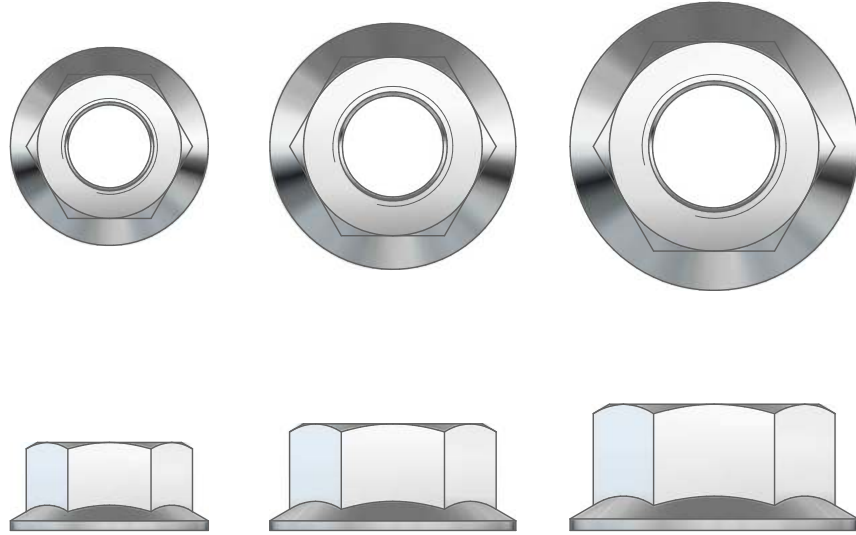

Nut Sizes	1/2"	5/8"	3/4"
Thread Per Inch (TPI) - Course	13	11	10
Thread Per Inch (TPI) - Fine	20	18	16
Width Across the Flats	0.750"	0.931"	1.091"
Width Across Corners	0.866"	1.083"	1.299"
Flange Diameter	1.031"	1.281"	1.500"
Thickness	0.458"	0.555"	0.657"

"Width Across the Flats" is the same as "Wrench Size"

